

4. Attach Top Wire

1. Attach Lower Wire Panel

Place the rear hooks of Lower Wire Panel on Top Frame as shown.



2. Attach Upper Wire Panel

Place Upper Wire Panel on Top Frame as shown in step 1.

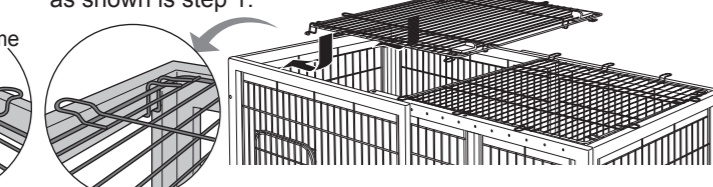

3. Fix Upper and Lower Wire Top Panels on Top Frame

Slide Locks outward to fix Upper and Lower Wire Top Panels on Top Frame as shown.

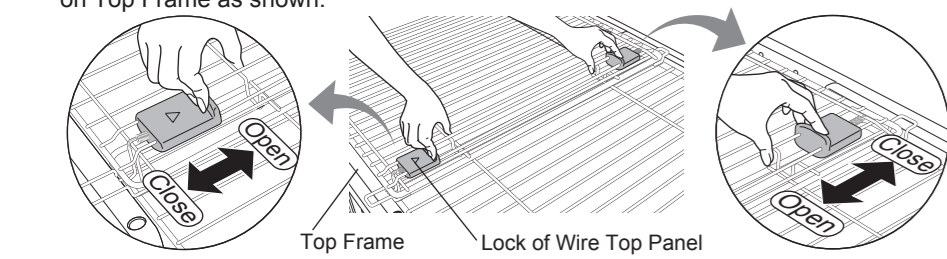

How to open/close Side Door

- Slide the right and left Locks upward.
- Open Side Door.
- Hooking Locks at the top of wire keeps Side Door open.

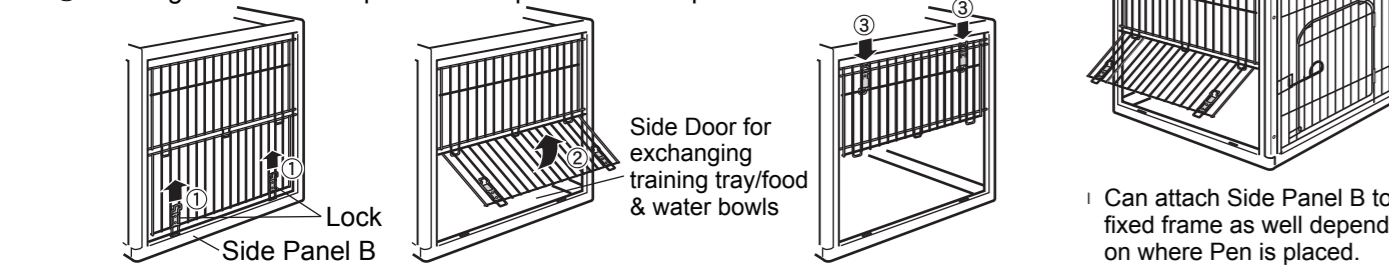

How to open/close Door

- Turn the Lock upward as shown.
- Slide it sideways.
- Open the Door.

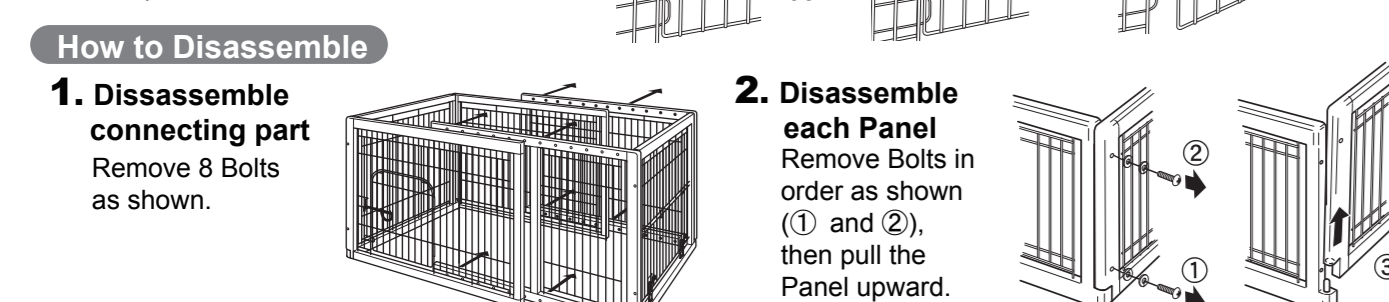

How to clean

- To clean, use mild detergent and water with soft cloth / sponge. Do not use harsh chemicals such as benzene or thinner.
- Cleaning this product with harsh abrasives or scrubbing brush may cause surface scratches.
- Follow the manufacturer's cleaning instructions if using cresol or other antiseptics.
- After cleaning, wipe dry with a soft cloth or place in shaded area to air dry, do not place product in direct sunlight.

Specifications

Product Name	Wooden Expandable Crate - RL		
Dimension	Pen: 35.4-60.6" L x 30.3" W x 27.6" H	Tray: 37 - 62.2" W x 32.1" D x 1" H	Wire Top: 35.4 - 60.6" W x 28.5" D x 2.8" H
Materials	Frame : Rubber wood (Lacquer finished)	Wire : Steel (Polyester coating)	
	Tray · Lock : ABS resin	Slip resistance : Elastomer	
Appropriate pet weight	Dogs 8.8 - 44 lbs		

- Please note that product specifications and design may change without prior notice for the purpose of the quality improvement.
- There may be coating cracks at some joints and each product may experience different coloration of the wood grain as frame are made of natural wood.

Designed by:
Richell Corporation, Japan

Distributed by:
Richell USA, Inc.
Grand Prairie, Texas 75050
Phone (972) 641-6795 Fax (972) 641-8495
Visit us at www.richellusa.com
MADE IN CHINA



Richell™

Instruction Manual

Wooden Expandable Crate - RL

U.S. Patent No. 8, 141, 517

Please read this instruction manual carefully before using this product, and keep for future reference. If you give this product to someone else, please also give this instruction manual. Please note some parts of the figures shown may be slightly different from the actual product, for your better understanding of the structure and proper use.

Features

- This product is designed exclusively for dogs.
- Wooden frame blends beautifully with most home decors.
- Adjustable size to accommodate pet growth and space needs.
- Side Door provides easy access to training tray and/or food and water bowls.

Parts

Before assembling this product, make sure the following parts are included:

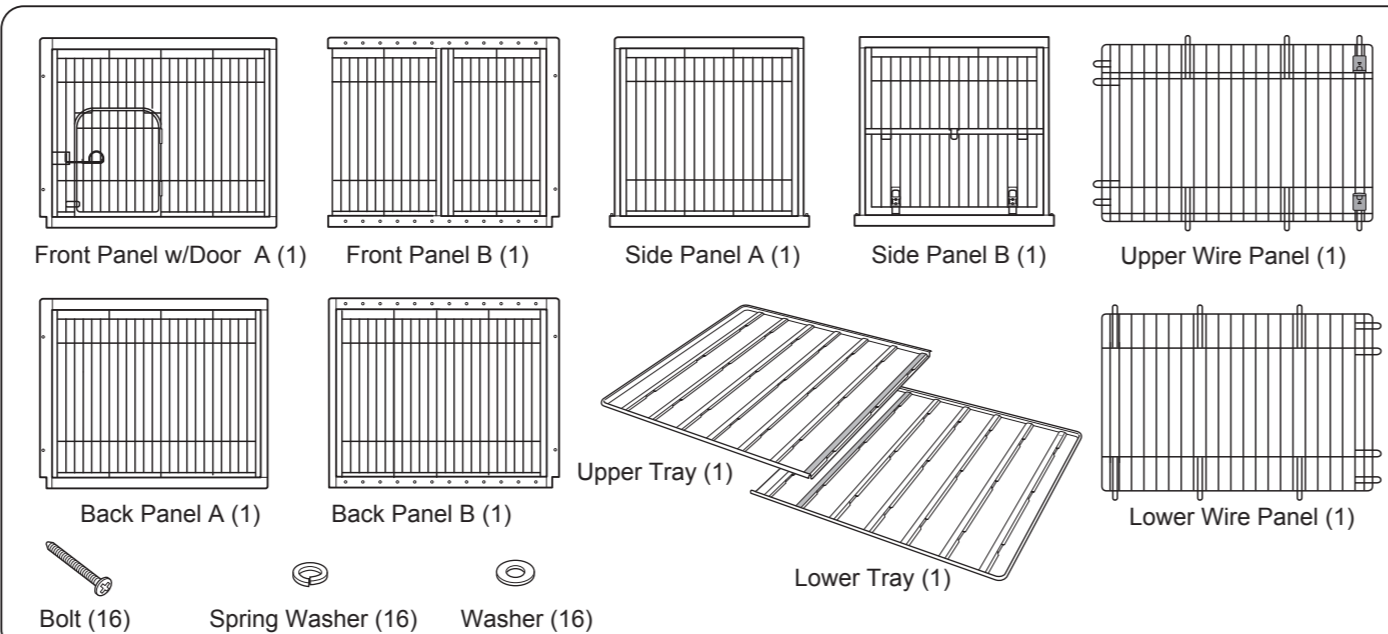

What are the following signs?

The following signs are special remarks for safety use of the product. Keep these remarks in mind before using this product.

Warning! : Remarks on inappropriate use which might cause serious injury and/or physical damage.

Caution! : Remarks on inappropriate use which might cause slight injury and/or physical damage.

Important! : Remarks on inappropriate use which might cause trouble, damage and/or shorter life.

Instruction for Proper Use

Warnings!

- Do not use this product while your pet is leashed to avoid unexpected accidents/injuries, such as dog entanglement.
- Make sure each part is properly fixed in place and pay special attention to new-born pups or tiny dogs to avoid unexpected serious injury/damage to pets, and/or product by being caught between the wires or between wire and wooden frame.
- Keep this product in sight and keep the Door open when unattended to avoid unexpected injury or death to your pet, pets behave unexpectedly when startled by thunder, lightning, or by other animals.

Cautions!

- When opening/closing the Door or Wire Top, be careful not to pinch your hands, fingers, or pet. Make sure the Door/Wire Top is locked to keep your pet safely confined to avoid unexpected injury and/or escape.
- Do not lean or sit on this product to avoid unexpected personal accidents and/or product damage.
- Only use genuine parts and do not alter the product to avoid accidents and/or trouble.
- Keep this product away from all heat sources at all times to avoid unexpected product damage or burn-related injuries to persons/pets.
- If there is something wrong with the product or its installation site, discontinue its use at once.
- Be careful of sharp objects when assembling or using this product.
- Do not grasp Top Panels when moving the product, as they will come off, which may cause injury and/or accidents.

Important!

- This product is designed for indoor use only. Do not use it outdoors.

How to assemble

Use a Phillips-head or flat-head screwdriver for assembly.

1. Attach Panels

1-1. Attach Fixed Frame

- Align the two corners and insert the Dowel into the Hole of L-shaped corner.
- Tighten upper side using Bolt.
- Tighten lower side using Bolt.

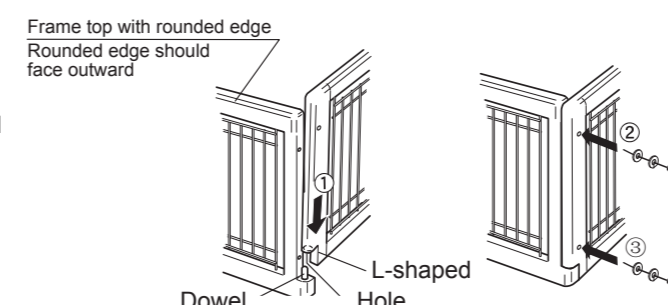
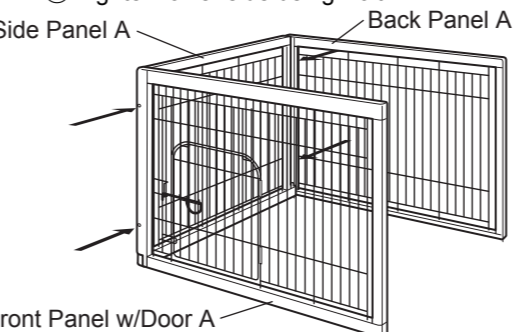

How to screw

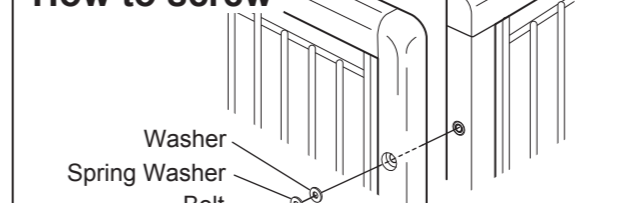

1-2. Attach Adjustable Frame

Align the two corners as shown and attach them using Bolts at the 4 arrow points indicated.

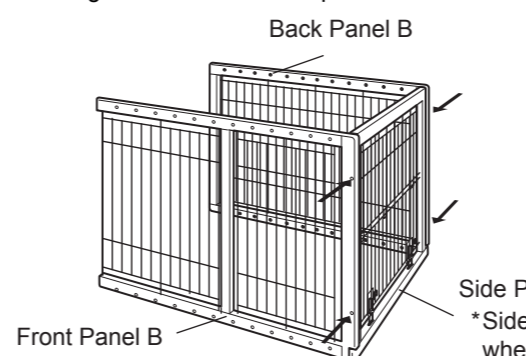

For the opening width 35.4 - 48"

Attach Front Panel B after removing two top bolts and Wire panel near the Door as shown.

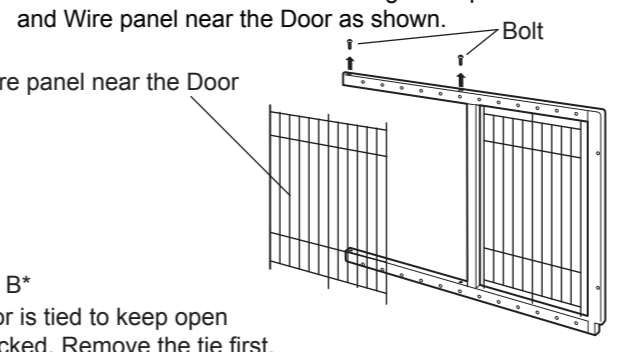

2. Attach Fixed and Adjustable Frames

Tighten the fixed and the adjustable frames using Bolts at 8 points as shown.

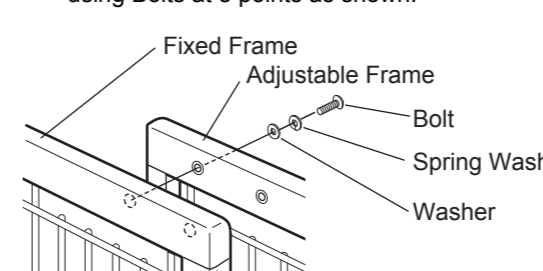
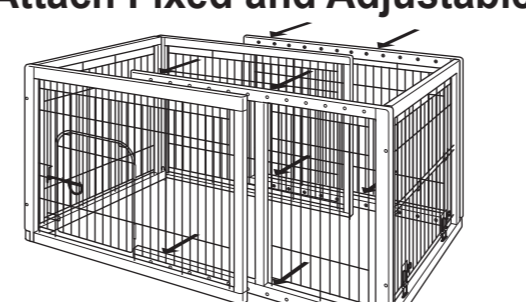

Be sure to tighten Bolts at the points shown on the following chart (see p.3) according to the designated width.

3. Attach Trays

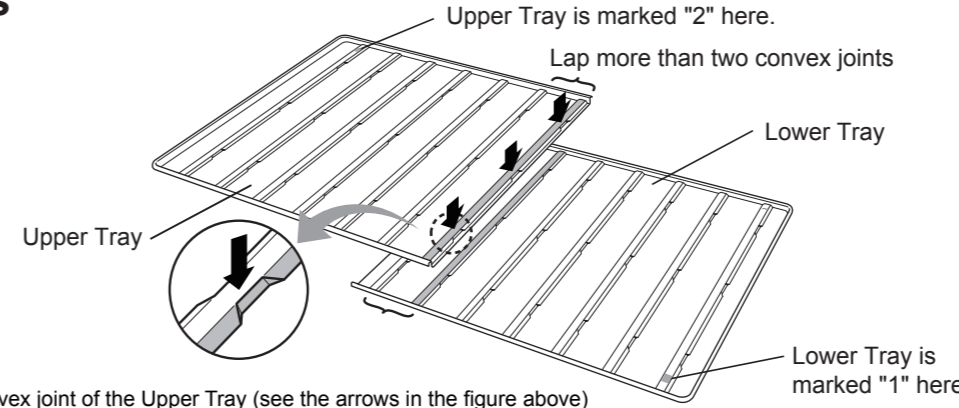

Firmly press the front-row convex joint of the Upper Tray (see the arrows in the figure above) until the both Trays are fixed. (Only the front-row convex has joint fixing grooves.)

Fixed and Adjustable Frame Options

Where to screw (at the same points on the Front/Back Panels)	Product Width
	35.4"
	38"
	40.5"
	43"
	45.5"
	48"
	50.6"
	53.1"
	55.6"
	58.1"
	60.6"